



malema sensors

PADDLE FLOW SWITCH FOR LIQUIDS

FS25R - WATER PROOF **FS25X** - EXPLOSION PROOF

Easy installation into existing pipe
For a wide range of pipe sizes from diameter 25 to 200
Adjustable set point
Reed switch provide a SPDT contact function
Max. pressure rating 1500 psi (st. steel)

Technical Data

FS25R

Operation temperature: -30 ~ +120°C
Reed switch: 250VAC/DC 60W/VA
Carrying current: 1A
Wire conduit: ½" NPTF
Protection class: IP65
Material: Body – 316SS + Teflon
 Plate – stainless steel 430
Optional: other materials available upon request

Pipe Size	Set Point Range for Water m³/h		Pressure Connection NPT
	Acuate (ON)	Deacuate(OFF)	
1"	1.4	1.05	1"
1¼"	1.45	1.1	1"
1½"	1.5-2	0.9-1.5	1"
2"	3-4	2-4	1"
2½"	4-5	3-4	1"
3"	6-7	5-6	1"
4"	8-10	10-14	1"
6"	12-17	20-30	1"
8"	25-30	30-35	1"

FS25X

Operation temperature: -30 ~ +120°C
Reed switch: 250VAC/DC 60W/VA
Carrying current: 1A
Wire conduit: ½" NPTF
Protection class: Explosion proof; EExdIICT
Material: Body – 316SS + Teflon
 Plate – stainless steel 430
Optional: other materials available upon request

NOTE
 Performance Technical Data are effective with date of issue and are subject to change without prior notice.

Pipe Size	Set Point Range for Water m³/h		Pressure Connection NPT
	Acuate (ON)	Deacuate(OFF)	
1"	1.4	1.05	1"
1¼"	1.45	1.1	1"
1½"	1.5-2	0.9-1.5	1"
2"	3-4	2-4	1"
2½"	4-5	3-4	1"
3"	6-7	5-6	1"
4"	8-10	10-14	1"
6"	12-17	20-30	1"
8"	25-30	30-35	1"



Dimensions

FS25R

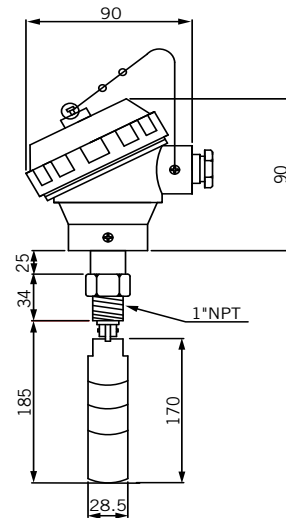

unit=mm

FS25X

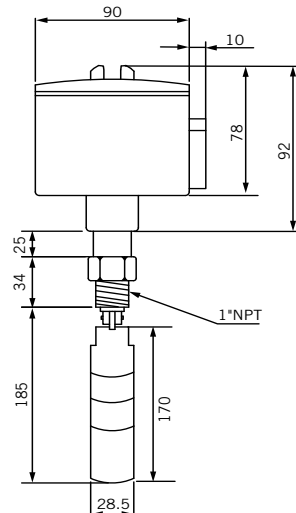

unit=mm